

- NOTES:**
1. All work to be done on these plans shall be done in conformity with applicable provisions of the San Francisco Building Code.
 2. B.P. 1748 shall be constructed and shown in plan view.
 3. All work shall be done in accordance with the field notes.

D.M. 2211, 1934
 D.M. 2211, 1934

DATE	1934
BY	D.M.
CHECKED	
APPROVED	

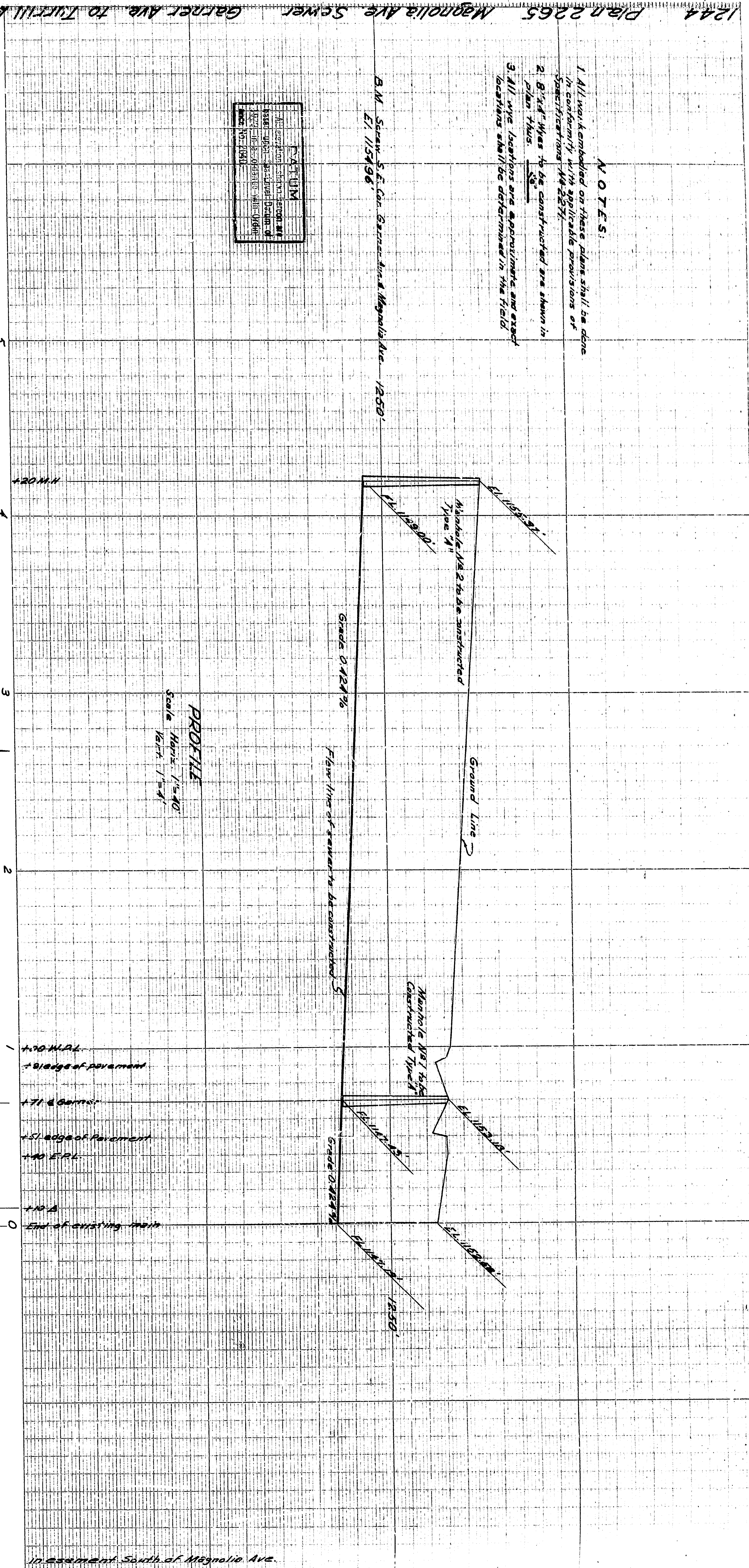

PROFILE
 Scale 1" = 4'
 Scale 1" = 20'

PLAN
 Scale 1" = 20'

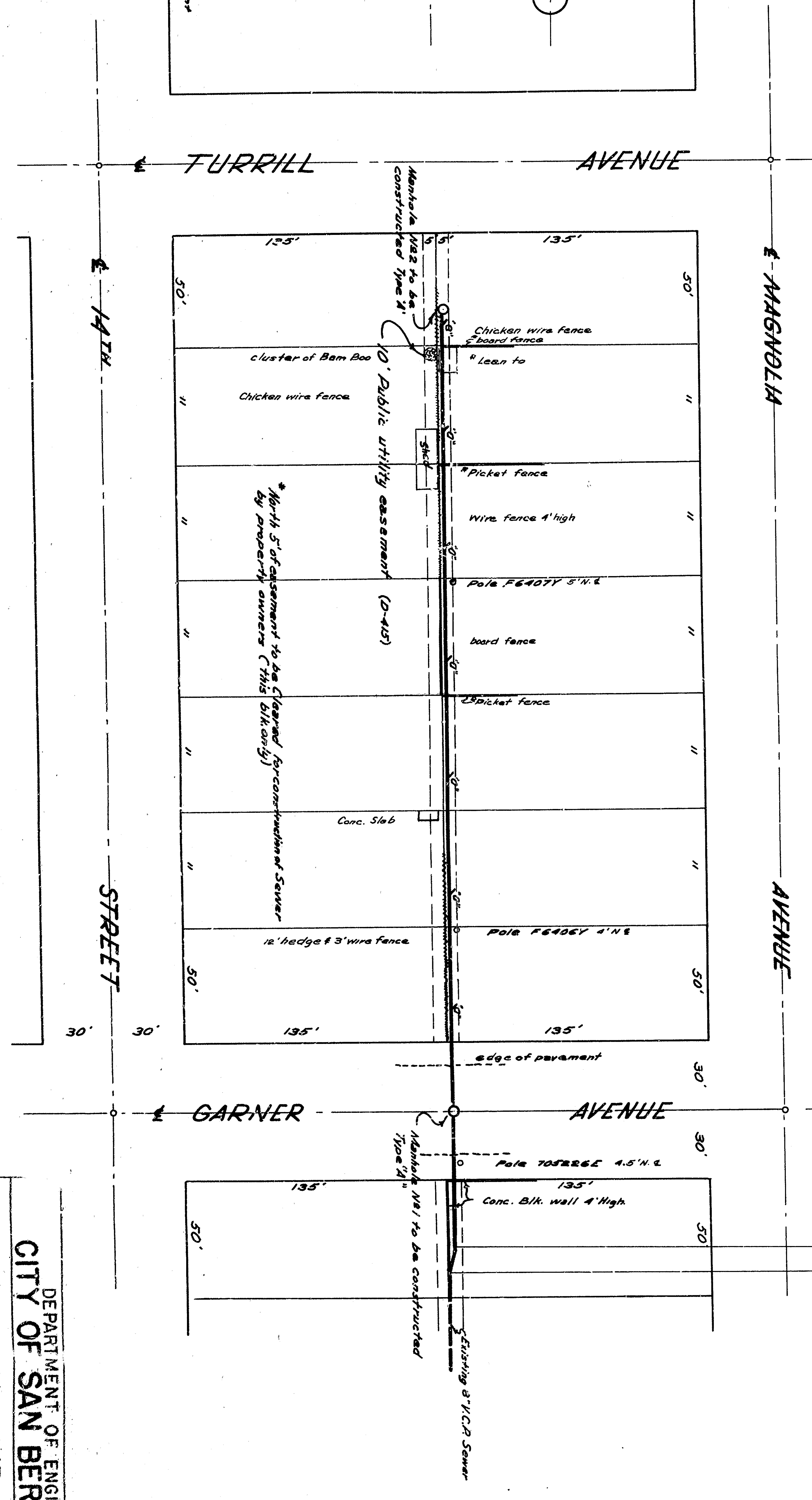
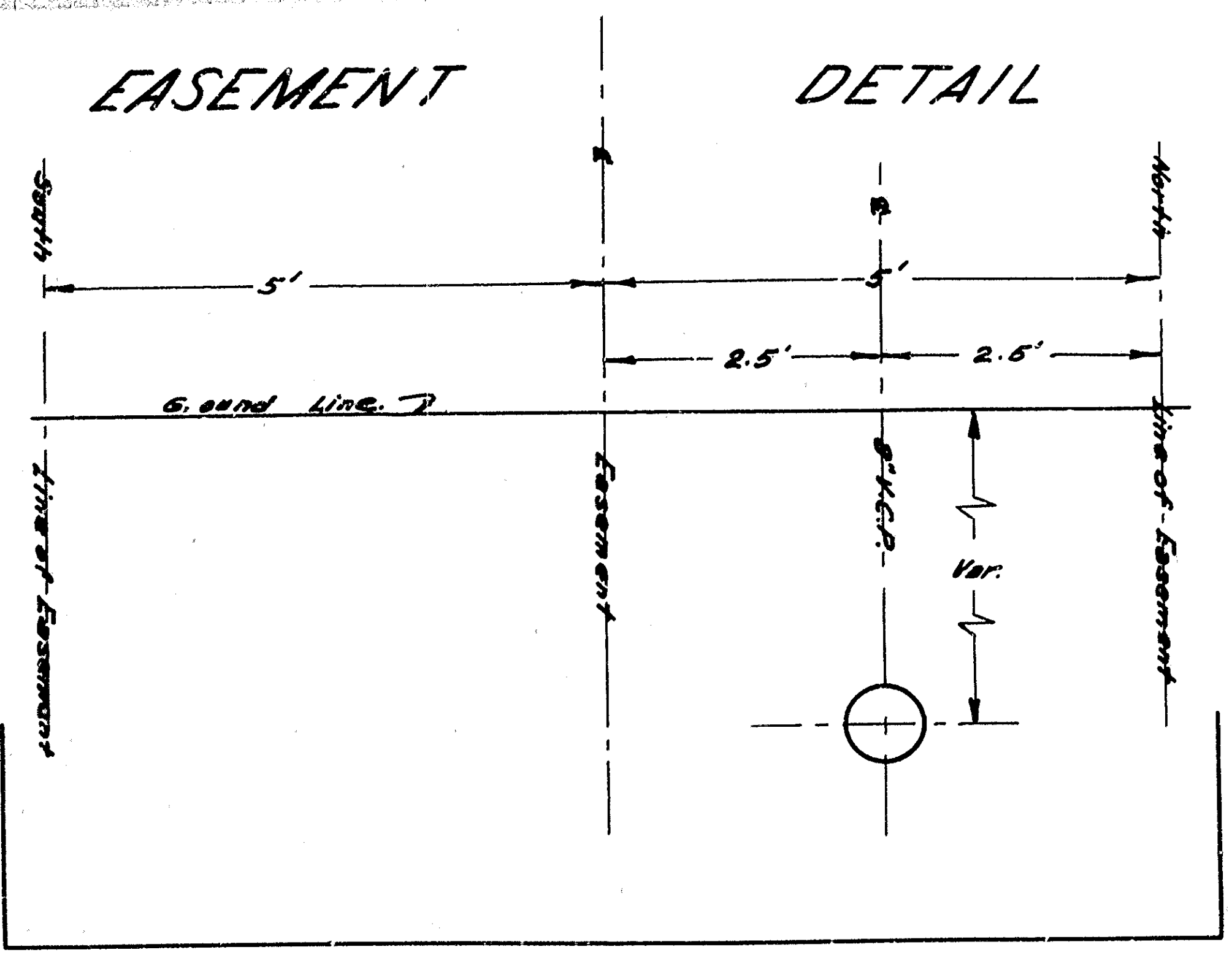

Plan 2265 Magnolia Ave. Sewer Garner Ave. to Turfill Ave. in easement South of Magnolia Ave.

1244

DEPARTMENT OF ENGINEERING
 CITY OF SAN BERNARDINO
 MAGNOLIA AVE. SEWER
 GARNER AVE. TO TURFILL AVE.
 EASEMENT SOUTH OF MAGNOLIA AVE.

SUBMITTED BY: *[Signature]*
 APPROVED: *[Signature]*
 FIELD CIVIL ENGINEER NO. 7045

DATE: May 9, 1935
 SHEET NO. 2265
 OF 1 SHEETS